

Parkheath

Sold on Service

Westbere Road NW2
£850,000



Superb 3 bedroom 2 bathroom garden apartment
Fantastic blend of contemporary and period features
Stunning 40' south facing rear garden
Large cellar storage area

Bright 22' open plan kitchen reception room leading to garden

South Hampstead Office 020 7625 4567
West Hampstead Office 020 7794 7111

Tastefully refurbished throughout by current owners
920 sq ft / 86 sq m

Separate private access to garden

Striking 16'9" master bedroom bedroom with en-suite and built in storage

0.6m to West Hampstead Thameslink, 0.8m to West Hampstead station (Jubilee and overground) and 0.5m to Kilburn (Jubilee)

Westbere Road

Approximate Gross Internal Area = 86 Sq m / 920 sq ft

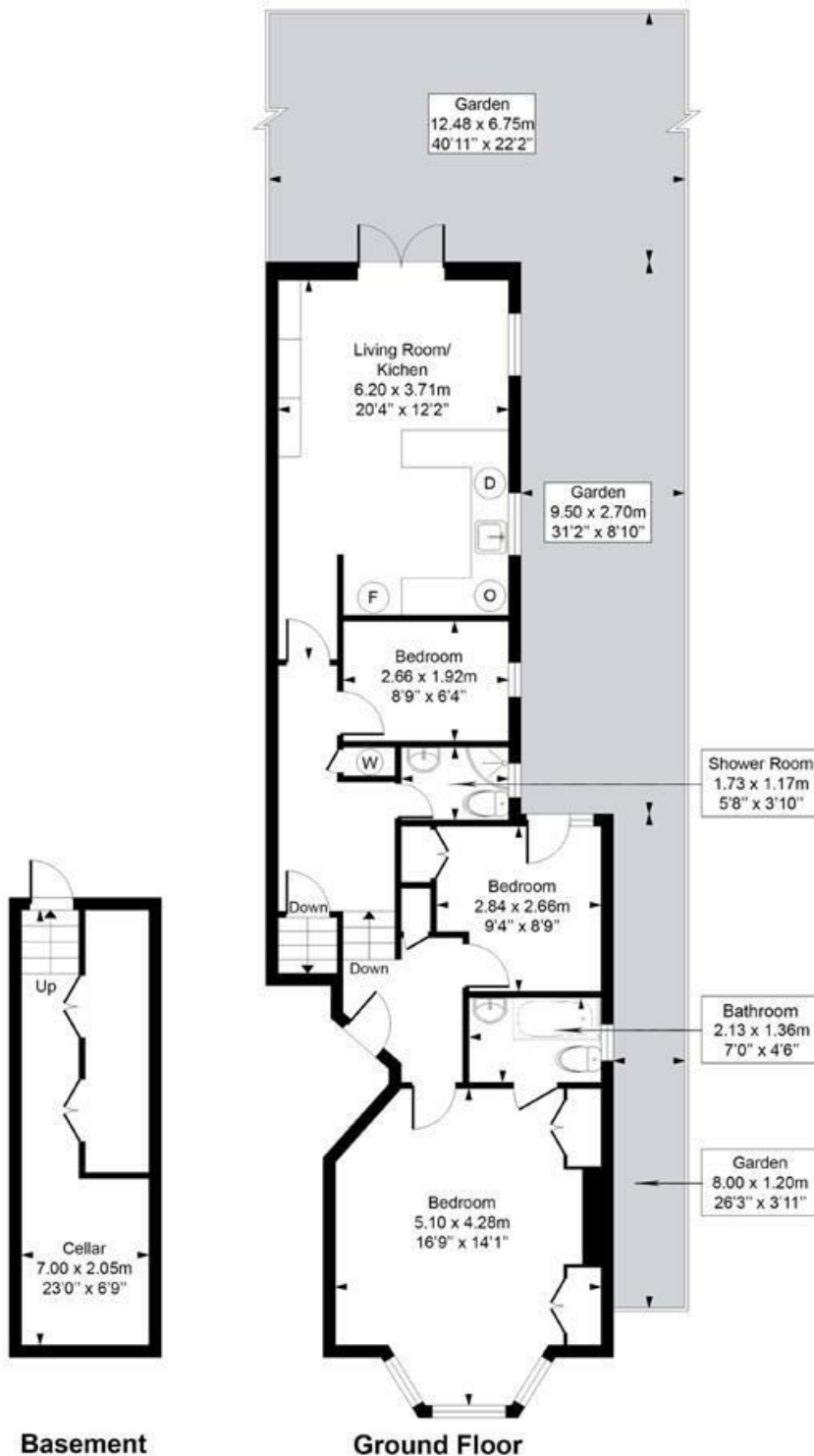

Measured in accordance with RICS guidelines. Every attempt is made to ensure accuracy
 However all measurements are approximate.
 The floor plan is illustrative purposes only and is not to scale
 ELLIE CLAIRE PHOTOGRAPHY LTD
www.ellieclairephotography.com

The particulars do not constitute part of an offer or contract. The particulars, including text, photographs and plans, are for the guidance only of prospective purchasers/tenants and must not be relied upon as statements of fact. The descriptions provided therein represent the opinion of the author and whilst given in good faith should not be construed as statements of fact. Nothing in these particulars shall be deemed a statement that the property is in good condition or otherwise or that any services or facilities are in good working order. All measurements are approximate